

LEGEND

- EXISTING & ARCHITECTS LEVELS
- PROPOSED LANDSCAPE LEVELS
- EXISTING TREES TO BE RETAINED
- EXISTING TREES TO BE REMOVED
- NEW TURF AREAS: SOFT LEAF BUFFALO
- PEBBLE MULCH
- UNIT PAVING
- MASONRY WALLS
- FEATURE MASONRY WALLS
- BRICK GARDEN EDGING
- STEPPING STONES

SCHEDULE OF EXISTING TREES

KEY	BOTANICAL NAME	COMMON NAME	HEIGHT X SPREAD
1.	<i>Populus deltoides</i>	Eastern Cottonwood	16 x 9m
2.	<i>Pittosporum undulatum</i>	Native Daphne	9 x 8m
3.	<i>Quercus robusta</i> #	English Oak	12 x 18m
4.	<i>Liriodendron tulipifera</i>	Tulip Tree	11 x 9.5m
5.	<i>Alnus jorallensis</i>	Mexican Alder	6 x 8m
6.	<i>Alnus jorallensis</i>	Mexican Alder	7 x 8m
7.	<i>Alnus jorallensis</i>	Mexican Alder	6 x 4.5m
8.	<i>Alnus jorallensis</i>	Mexican Alder	7 x 7.5m
9.	<i>Callistemon salignus</i>	Willow Bottle Brush	6 x 4m
10.	<i>Chamaecyparis obtusa</i> #	Hinoki Cypress	9 x 3m
11.	<i>Platanus hybrida</i>	London Plane Tree	12 x 17m
12.	<i>Olmus procera</i> 'Argenteo-variegata'	Silver Elm	10 x 10m
13.	<i>Chamaecyparis obtusa</i>	Hinoki Cypress	9 x 3.5m
14.	<i>Liquidambar styraciflua</i> #	Sweet Gum	14 x 15m
15.	<i>Cupressus macrocarpa</i> 'Compebeartii Aurea'	Weeping Golden Cypress	14 x 3m
16.	<i>Cupressus macrocarpa</i> 'Compebeartii Aurea'	Weeping Golden Cypress	13 x 10m
17.	<i>Cupressus macrocarpa</i> 'Compebeartii Aurea'	Weeping Golden Cypress	12 x 7m
18.	<i>Juniper chinensis</i> 'Keteleeri'	Chinese Juniper	7 x 4m
19.	<i>Liquidambar styraciflua</i>	Sweet Gum	12 x 15m
19A.	<i>Acer palmatum</i>	Japanese Maple	6 x 6m
20.	<i>Liquidambar styraciflua</i>	Sweet Gum	7.5 x 3m
21.	<i>Metaleuca quinquenervia</i>	Broad Leaf Paperbark	16 x 9m
22.	<i>Franklinia axillaris</i>	Fried Egg Plant	3 x 4m
23.	<i>Franklinia axillaris</i>	Fried Egg Plant	3 x 3m
24.	<i>Acacia baileyana</i>	Cootamundra Wattle	7.5 x 6m
25.	<i>Nyssa sylvatica</i>	Tupelo	6 x 8m
26.	<i>Nyssa sylvatica</i>	Tupelo	9 x 7.5m

SCHEDULE OF PLANT MATERIAL

CODE	BOTANICAL NAME	COMMON NAME	QUANTITY	MATURE HEIGHT	CONTAINER SIZE	STAKES
AC	<i>Angophora costata</i> #	Red Sydney Gum	4	25m	25 litre	2
ACI	<i>Adiantum cuneatum</i>	Renssela Renssela Lily	1m	200mm	-	-
ACU	<i>Archontophoenix cunninghamiana</i>	Bangalow Palm	3	10m	25 litre	2
AT	<i>Allocasuarina torulosa</i> #	Forest Oak	4	13m	25 litre	2
BM	<i>Backhousia myrtifolia</i>	Grey Myrtle	4	4m	25 litre	2
BO	<i>Breynia oblongifolia</i>	Breytia	20	2m	200mm	-
CA	<i>Cyathea australis</i>	Rough Tree Fern	13	2.5m	200mm	-
CAN	<i>Cissus antarctica</i>	Kangaroo Vine	23	prostrate	140mm	-
CGU	<i>Ceratopetalum gummiferum</i>	NSW Christmas Bush	3	5m	25 litre	2
CM	<i>Clivia miniata</i>	Kaffir Lily	186	0.4m	140mm	-
DA	<i>Doodia aspera</i>	Rasp Fern	60	0.4m	140mm	-
DC	<i>Dianella caerulea</i>	Paroo Lily	416	0.4m	140mm	-
DE	<i>Doryanthes excelsa</i>	Gymea Lily	39	1.5m	200mm	-
DT	<i>Dodonaea triquetra</i>	Hop Bush	7	2m	200mm	-
EP	<i>Eucalyptus pilularis</i> #	Blackbutt	1	25m	25 litre	2
EPa	<i>Eucalyptus paniculata</i> #	Grey Ironbark	3	20m	25 litre	2
EPp	<i>Escallonia 'Pink Pixie'</i>	Pink Pixie Escallonia	23	1m	140mm	-
ER	<i>Elaeocarpus reticulatus</i> *	Blueberry Ash	20	5m	25 litre	2
GF	<i>Gardenia 'Florida'</i>	Gardenia	21	1m	200mm	-
IA	<i>Indigophora australis</i>	Native Indigo	5	1.5m	200mm	-
KA	<i>Kunzea ambigua</i>	Tick Bush	10	2m	200mm	-
LF	<i>Lomandra fluvialis</i>	Fine Leaf Lomandra	375	0.4m	140mm	-
LI	<i>Lagerstroemia indica</i> *	Crepe Myrtle	5	7m	25 litre	-
Ljr	<i>Liriope 'Just Right'</i>	Tuft Lily	73	0.4m	140mm	-
LT	<i>Lomandra longifolia</i>	Mat Rush	113	1m	140mm	-
LT	<i>Liriodendron tulipifera</i> #	Tulip Tree	1	15m	25 litre	2
ND	<i>Nandina domestica</i>	Sacred Bamboo	62	1.5m	200mm	-
NS	<i>Nyssa sylvatica</i> #	Tupelo	1	15m	25 litre	2
OD	<i>Ozothamnus diosmifolius</i>	Sago Flower	17	2m	200mm	-
PC	<i>Pyrus calleryana</i> 'Chanticleer' *	Ornamental Pear	4	7.5m	75 litre	-
PTI	<i>Phormium tenax</i> 'Flamin'	Red NZ Flax	103	1m	200mm	-
PR	<i>Pittosporum revolutum</i>	Yellow Pittosporum	15	3m	200mm	-
Pro	<i>Phoenix roebelenii</i>	Pigmy Date Palm	6	3m	200mm	-
ROI	<i>Rosmarinus officinalis</i> 'Irene'	Rosemary	8	0.75m	200mm	-
SAe	<i>Syzygium australe</i> 'Elegance'	Dwarf Lilli Pilli	60	1.5m	200mm	-
SAr	<i>Syzygium australe</i> 'Resilience'	Dwarf Lilli Pilli	93	3m	200mm	-
SG	<i>Syncarpia glomulifera</i> #	Turpentine	10	20m	25 litre	2
SR	<i>Strelitzia reginae</i>	Bird Of Paradise	17	1.5m	200mm	-
VO	<i>Viburnum odoratissimum</i>	Sweet Viburnum	26	3m	200mm	-
VT	<i>Viburnum tinus</i>	Laurestinus	21	3m	200mm	-

# 24 x proposed canopy trees to attain a minimum height of 13m on shale derived soils.  
\* 29 x proposed landscape (small) trees.  
The majority of the plants in this schedule have been selected from a list of indigenous Sydney Turpentine Ironbark Forest species and also in Ku-ring-gai Council's indigenous plant list within the BASiS Specification.

REVISIONS

- 18.03.11
- Revisions to courtyard paving to match architectural plans.
  - Revisions to retaining walls in south-east corner.

Verify all dimensions on site before commencing construction or ordering materials. Verify the dimensions of all manufactured products before installation. Use figured dimensions in preference to scaled dimensions. Report any discrepancies to the Landscape Architect for a decision before work commences.

NOTES

This plan is to be read in conjunction with all documentation prepared by Greenbox Architecture Pty Ltd.



office, 16/303 pacific highway  
lindfield nsw 2070  
postal, 25 bent street  
lindfield nsw 2070  
ph 9416 4290 fax 9416 4735  
A.C.N 097 328 580  
email ilja@netspace.net.au

project  
Residential Development  
165-167 Rosedale Road, St. Ives

drawing  
Landscape Plan

client  
Samarani Developments Pty Ltd  
date  
March 2011  
job.dwg no.  
219.11(10)427  
designed by  
IJ  
scale  
1:100 @ A0  
1:200 @ A2  
no. in set  
ONE/TWO  
drawn by  
GM/AM

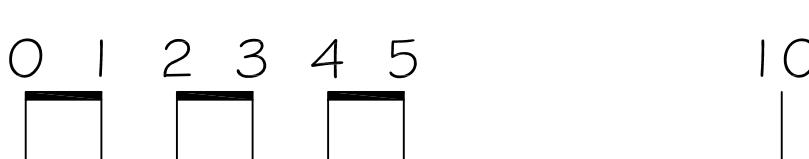
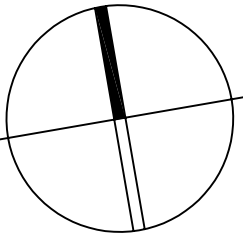
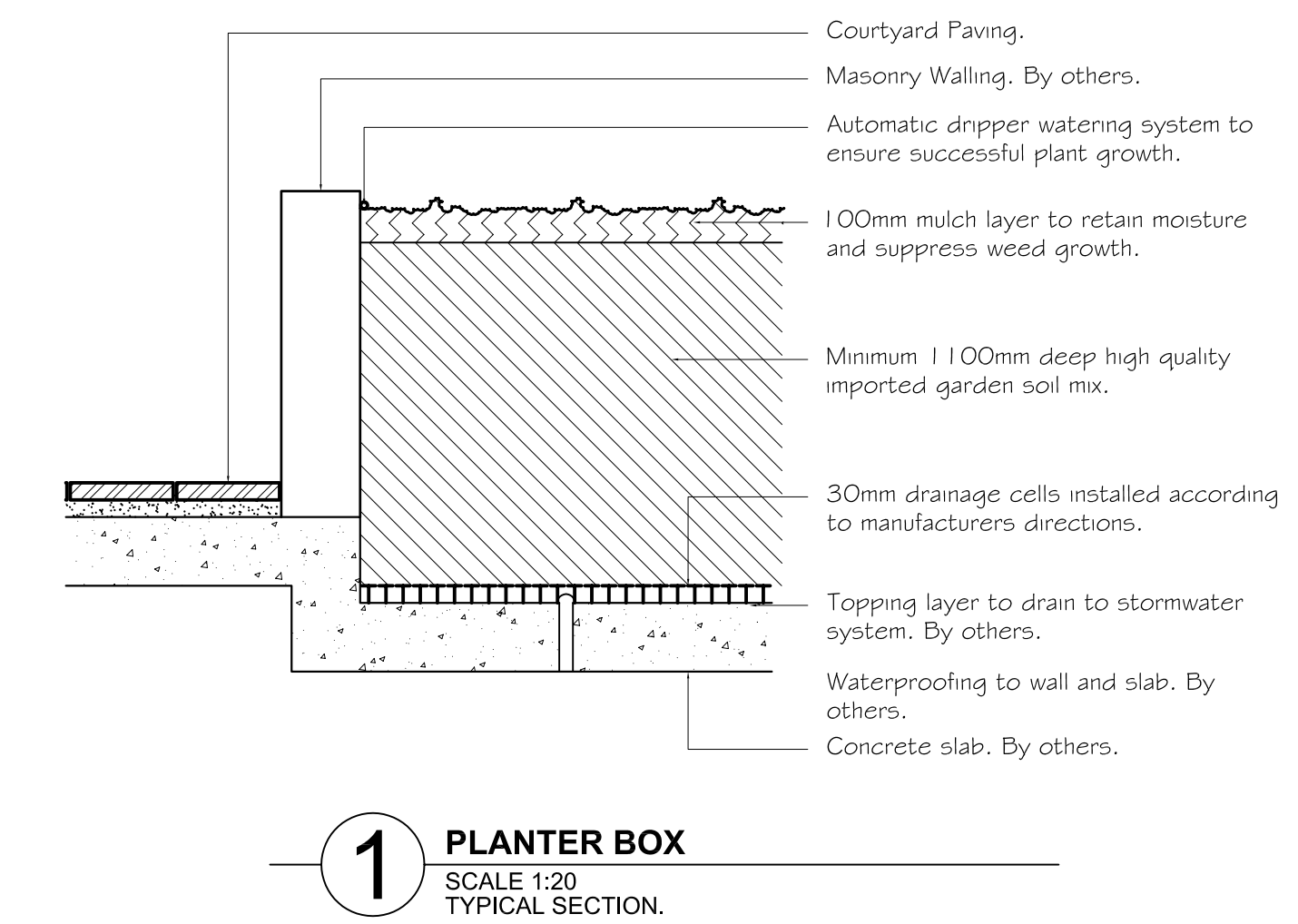



EXISTING & ARCHITECTS LEVELS

+ 65.20 PROPOSED LANDSCAPE LEVELS

 EXISTING TREES TO BE REMOVED



PEBBLE MULCH

 MASONRY WALLS

### FEATURE MASONRY WALLS

 BRICK GARDEN EDGING

□□□□ STEPPING STONES



LOW WATER USE PLANTING

KEY	BOTANICAL NAME	COMMON NAME	HEIGHT X SPREAD
-----	----------------	-------------	-----------------

1.	<i>Populus deltoides</i>	Eastern Cottonwood	16 x 9 m
2.	<i>Piptoporus undulatum</i>	Native Dahpne	9 x 8 m
3.	<i>Quercus robusta</i> #	English oak	12 x 18 m
4.	<i>Liriodendron tulipifera</i>	Tulip Tree	11 x 9.5m
5.	<i>Alnus praelensis</i>	Mexican Alder	16 x 8 m
6.	<i>Alnus praelensis</i>	Mexican Alder	7 x 8 m
7.	<i>Alnus praelensis</i>	Mexican Alder	6 x 4.5 m
8.	<i>Alnus praelensis</i>	Mexican Alder	7.5 m
9.	<i>Callistemon salignus</i>	Willow Bottle Brush	9 x 4 m
10.	<i>Chamaecyparis obtusa</i> #	Hinoki Cypress	6 x 3 m
11.	<i>Platanus arida</i>	Arizonan Sycamore Tree	12 x 17 m
12.	<i>Olmus procera</i> 'Argenteo-variegata'	Silver Elm	12 x 17 m
13.	<i>Chamaecyparis obtusa</i>	Hinoki Cypress	9 x 3.5m
14.	<i>Liquidambar styraciflua</i> #	Sweet Gum	14 x 15m
15.	<i>Cupressus macrocarpa</i> 'Combiheari Aurea'	weeping Golden Cypress	14 x 3m
16.	<i>Cupressus macrocarpa</i> 'Combiheari Aurea'	weeping Golden Cypress	14 x 15m
17.	<i>Cupressus macrocarpa</i> 'Combiheari Aurea'	weeping Golden Cypress	12 x 7 m
18.	<i>Juniperus horizontalis</i> 'Keteleeri'	Chinese Juniper	7 x 4 m
19.	<i>Liquidambar styraciflua</i>	Sweet Gum	12 x 15m
19A.	<i>Acer palmatum</i>	Japanese Maple	6 x 6 m
20.	<i>Liquidambar styraciflua</i>	Sweet Gum	7.5 x 3 m
21.	<i>Melaleuca quinquenervia</i>	Broad Leaf Paperbark	16 x 3 m
22.	<i>Franklinia axillaris</i>	Fried Egg Plant	3 x 3 m
23.	<i>Franklinia axillaris</i>	Fried Egg Plant	3 x 4 m
24.	<i>Acacia baileyana</i>	Cootamundra Wattle	7.5 x 6 m
25.	<i>Nyssa sylvatica</i>	Tupelo	6 x 6 m
26.	<i>Nyssa sylvatica</i>	Tupelo	9 x 7.5m

ZONE	AREA
------	------

<b>COMMON AREAS</b>	
Lawn	610.87m <sup>2</sup>
Garden Areas	1454.61m <sup>2</sup>
Native/Low Water Use Planting	1033.36m <sup>2</sup> (71.04%)
<b>PRIVATE AREAS</b>	
<i>Building A</i>	
Unit 1	18.55m <sup>2</sup>
Native/Low Water Use Planting	18.55m <sup>2</sup> (100.00%)
Unit 2	7.33m <sup>2</sup>
Native/Low Water Use Planting	7.33m <sup>2</sup> (100.00%)
Unit 3	16.29m <sup>2</sup>
Native/Low Water Use Planting	16.29m <sup>2</sup> (100.00%)
Unit 4	18.35m <sup>2</sup>
Native/Low Water Use Planting	18.35m <sup>2</sup> (100.00%)
Unit 5	12.60m <sup>2</sup>
Native/Low Water Use Planting	12.60m <sup>2</sup> (100.00%)
Unit 6	4.90m <sup>2</sup>
Native/Low Water Use Planting	4.90m <sup>2</sup> (100.00%)
<i>Building B</i>	
Unit 7	13.17m <sup>2</sup>
Native/Low Water Use Planting	13.17m <sup>2</sup> (100.00%)
Unit 8	11.18m <sup>2</sup>
Native/Low Water Use Planting	11.18m <sup>2</sup> (100.00%)
Unit 10	22.57m <sup>2</sup>
Native/Low Water Use Planting	22.57m <sup>2</sup> (100.00%)
Unit 11	14.49m <sup>2</sup>
Native/Low Water Use Planting	14.49m <sup>2</sup> (100.00%)

**A** **21.03.11**

1. Revisions to courtyard paving to match architectural plans.
2. Revisions to retaining walls in south-east corner.

Verify all dimensions on site before commencing construction or ordering materials. Verify the dimensions of all manufactured products before installation. Use figured dimensions in preference to scaled dimensions. Report any discrepancies to the Landscape Architect for a decision before work commences.

This plan is to be read in conjunction  
with all documentation prepared by  
**Greenbox Architecture Pty Ltd.**



Office. 16/303 pacific highway  
indfield nsw 2070  
postal. 25 bent street  
indfield nsw 2070  
ph 9416 4290 fax 9416 4735  
A.C.N 097 328 580  
email [ijla@netspace.net.au](mailto:ijla@netspace.net.au)

project  
Residential Development

drawing  
Low Water Use Planting Plan

client	
Samarani Developments Pty Ltd	

date	scale
March 2011	1:100 @ A0
	1:200 @ A2

Job.dwg no.	no. in set
219.11(10)/439	TWO/TWO

designed by IJ	drawn by GM/AM
-------------------	-------------------

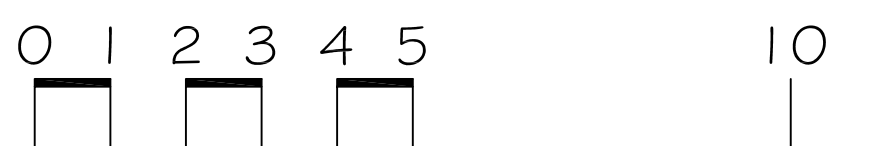
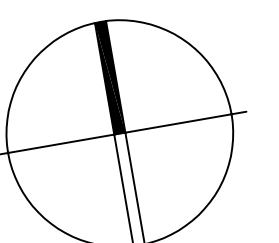



C:\Users\duncan.greenbox\Documents\Rosedale Road - CENTRAL\_duncan.n  
1/04/2011 3:31:30 PM

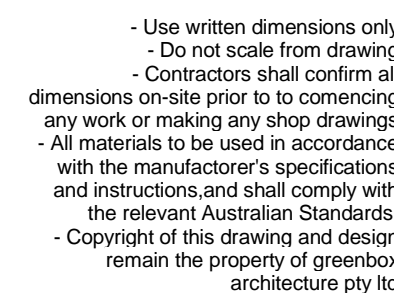

**greenbox**  
architecture

greenbox architecture Pty Ltd  
abn: 79 139 779 098  
Suite 31, Jones Bay Wharf  
26-32 Pirrama Rd  
Pyrmont, NSW 2009

p : 61 2 8069 8930  
w : [greenboxarchitecture.com](http://greenboxarchitecture.com)

A002	D
------	---

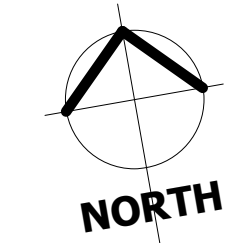

Revision	Description	Date
A	AMENDED DA ISSUE	25.03.11

- + CROSS-HATCHED AREA DENOTES EXTENT OF BASEMENT EXCAVATION
- + PIERING TO PERIMETER OF BASEMENT TO AVOID NEED FOR BATTERING
- + FOR SOIL AND EROSION CONTROLS SEE HYDRAULICS DRAWINGS
- + VEHICLE CROSSING TO INCORPORATE AREA FOR VEHICLE CLEAN-DOWN
- + 11M RIGID TRUCK SHOWN - ENTER AND LEAVE IN A FORWARD DIRECTION
- + VEHICLE ROUTES AS NOMINATED IN TRAFFIC REPORT AND WASTE MANAGEMENT PLAN
- + READ WITH CONSTRUCTION SITE PLAN

ROSEDALE ROAD

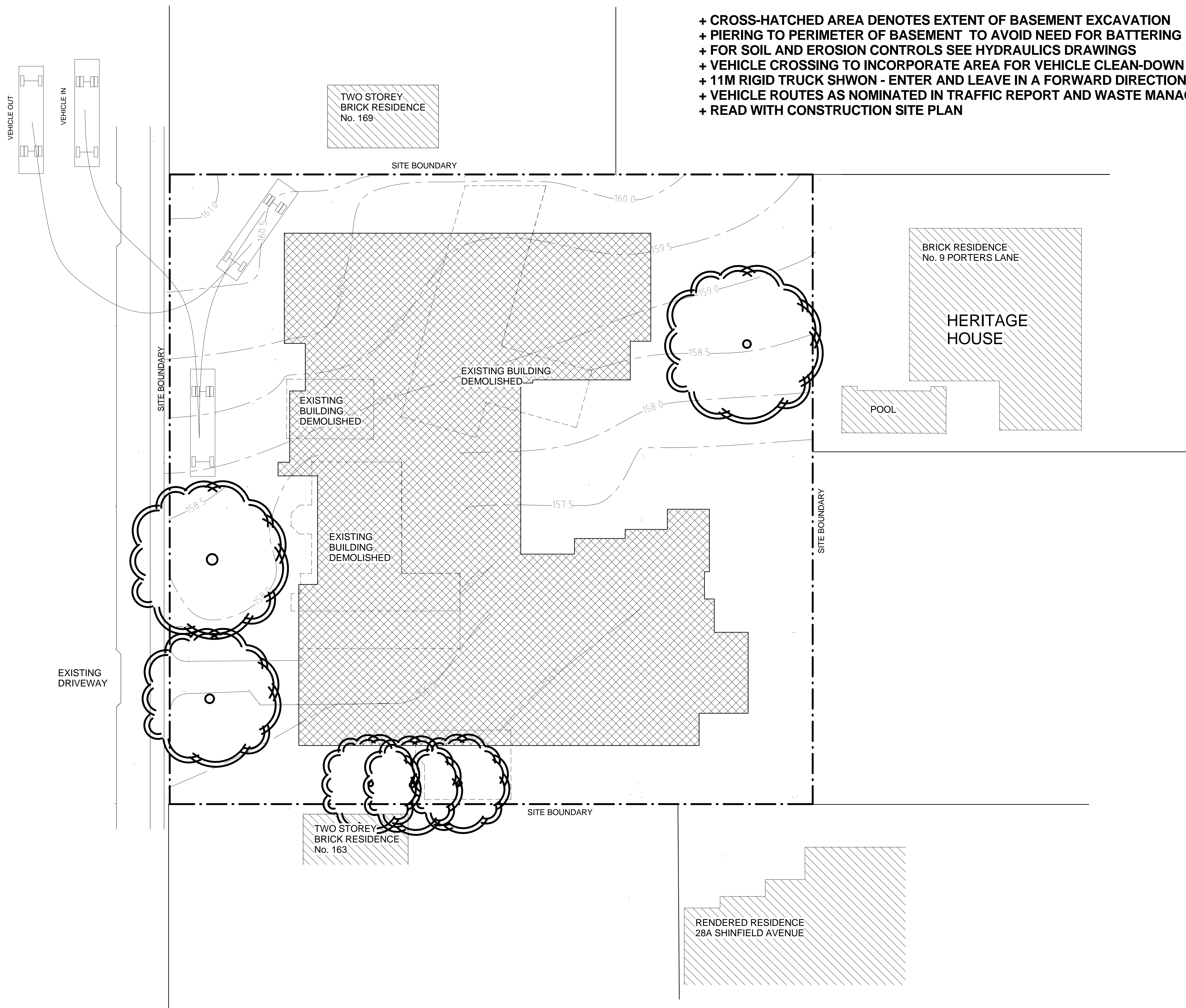

- Use written dimensions only
- Do not scale from drawing
- Contractors shall confirm all dimensions on-site prior to commencing any work or making any shop drawings
- All materials to be used in accordance with the manufacturer's specifications and instructions and shall comply with the relevant Australian Standards.
- Copyright of this drawing and design remain the property of greenbox architecture pty ltd

Project Status  
NOT FOR CONSTRUCTION

**greenbox**  
architecture  
greenbox architecture pty ltd  
abn: 79 138 779 098  
Suite 31, Jones Bay Wharf  
26-32 Pirrama Rd  
Pymont, NSW 2009  
p : 61 2 8069 8930  
w : greenboxarchitecture.com

Client  
SAMRANI DEVELOPMENTS PTY Ltd

Project Address  
165 - 167 ROSEDALE ROAD  
ST IVES

Drawing Title  
ENVIRONMENTAL SITE MANAGEMENT  
PLAN

Drawn	Scale	
Author	1 : 200	@ B1
Date	Job Number	
03/21/11	100301	
Drawing Number	Issue	

A006

A

1 SITE - ENVIRONMENTAL  
1 : 200